

Reactional torque transducer

Features

- Models that range 0.2 to 20 Nm
- Accuracy 0.2 % of full scale
- Standardized output signal
- Easy to handle
- Small compact

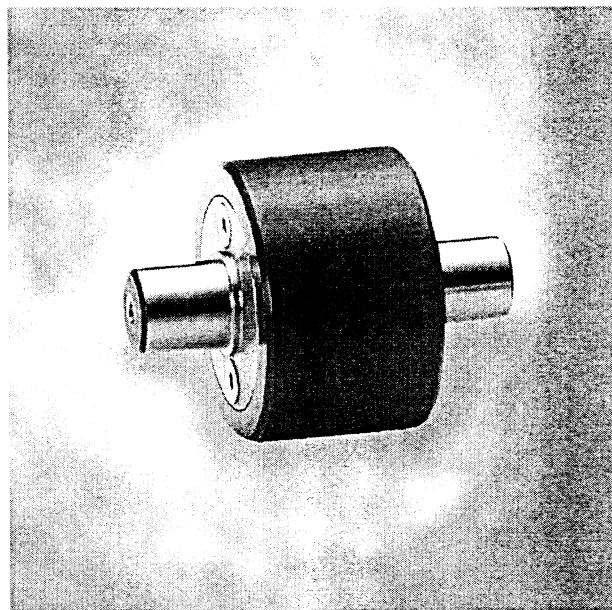

shaft end version 0154 RW

1. General information

Reactional torque transducers type 0154 RW are usable for static and quasistatic applications of torque measuring.

A recording of reactional torques at rotating machine elements is also possible.

By that way a maintenance-free torque measuring is possible.

The applications are suitable for adjusting torque at shut-off couplings, measuring of stirring devices and checking electric and pneumatic motors.

The construction was optimized concerning the length, weight (moment of inertia) and volume, for to minimize axial forces and bending load on the measuring element.

For special measuring assignments, the construction of our torque transducers can be adjusted to the respective application.

2. Electrical specifications

Excitation:	10 ... 12 V DC
Rated output:	1 mV/V
Bridge resistance:	350 Ω Nominal
Nominal temperature range:	-5 ... +45 °C
Operating temperature range:	-15 ... +55 °C

01.99

Reactional torque transducer RW

0154/01

Temperature influence at nominal range:	$\pm 0,01$ % of full scale/K (zero signal)
Linearity and hysteresis (both together)	$\pm 0,002$ % of nominal range/K (characteristics) $\leq \pm 0,2$ % of full scale
Overload capacity:	150 % of nominal range
Rupture torque:	300 % of nominal range
Protection class:	IP 50

Pin connection	Pin 1	- excitation
	Pin 2	+ excitation
	Pin 3	shield
	Pin 4	+ output signal
	Pin 5	- output signal
	Pin 6	100 % calibration signal
Mating connector: 6 pole connector article no.: 822 (Binder type : 99-2022-09-6)		

3. Mechanical specifications

Connection cable length: 2,5 m

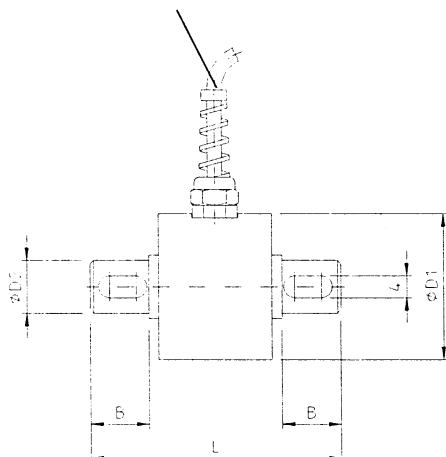

Nominal torque in Nm	L	Ø D1	Ø D2	B	Feather key slots *	Article No.
0.2	50	38	12	12	without	6036
0.5	50	38	12	12	without	6034
1	50	38	12	12	without	6033
2	50	38	12	12	2 x 180°	5648
5	50	38	12	12	2 x 180°	5653
10	50	38	12	12	2 x 180°	5794
20	50	38	12	12	2 x 180°	5784

* Both shaft ends with feather key slots (2 x 180°) acc. to DIN 6885, sheet. 1

◆ Example of order specification: 0154/01-2-5648

Accessories

- Industrial measuring amplifier datasheet 4115
- Digital indicator datasheet 4125
- 19" modul amplifier datasheet 4103



Sta. Virgilia 29 Local.1A 28033 Madrid
Tfno.: 91 764 21 00 Fax.: 91 764 21 32
www.guemisa.com Email.:info@guemisa.com

0154/01